

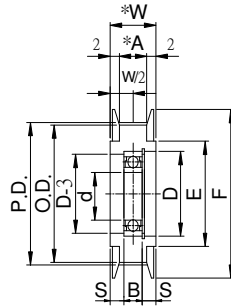

附法蘭 齒型惰輪 FLANGED IDLERS WITH TEETH < 8YU型 >



中心軸承型



兩側軸承型

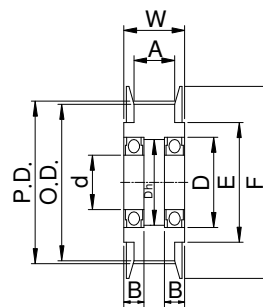
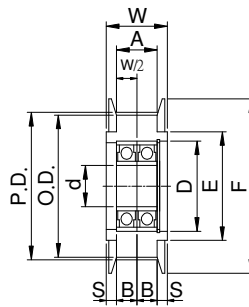

Type	材質	表面處理	法蘭材質	法蘭表面處理
IDAA	A6061	陽極	S45C	鍍鉍
IDAAA	A6061	陽極	AL	陽極
IDAH	A6061	硬陽	S45C	鍍鉍
IDAHA	A6061	硬陽	AL	硬陽
IDAD	A6061	黑色陽極	S45C	鍍鉍
IDADA	A6061	黑色陽極	AL	黑色陽極
IDSZ	S45C	染黑	S45C	染黑
ISZ	S45C	鍍鉍	S45C	鍍鉍
ISN	S45C	鍍鉍	S45C	鍍鉍
ISC	S45C	鍍鉍	S45C	鍍鉍
ISH	S45C	無電鍍	S45C	無電鍍
ISS	STU308	電解	A6061	陽極

▲8YU型 (中心軸承型)

Type	Catalog No.		P.D	O.D	F	E	A	W	S	軸承尺寸			使用扣環		
	齒數	齒面寬度A								No.	d	D	B	IDSS	IDSD
IDAA	20	8YU017	50.93	49.56	58	40	17	22	6	6201ZZx1	12	32	10	RTWS32	RTWN32
		8YU028													
IDAAA	22	8YU017	56.02	54.65	61	45	17	22	6	6201ZZx1	12	32	10	RTWS32	RTWN32
		8YU017													
IDAH	24	8YU017	61.12	59.74	67	50	17	22	6	6201ZZx1	12	32	10	RTWS32	RTWN32
		8YU028													
IDAHA	24	8YU033	61.12	59.74	67	50	33	38	8	6202ZZx2	15	35	11	RTWS35	RTWN35
		8YU044													
IDAD	25	8YU017	63.66	62.29	70	56	17	22	5.5	6202ZZx1	15	35	11	RTWS35	RTWN35
IDADA	26	8YU017	66.21	64.84	74	58	17	22	5.5	6202ZZx1	15	35	11	RTWS35	RTWN35
IDSZ	28	8YU017	71.30	69.93	80	60	17	22	5.5	6202ZZx1	15	35	11	RTWS35	RTWN35
IDSN	30	8YU017	76.39	75.02	87	67	17	22	5.5	6202ZZx1	15	35	11	RTWS35	RTWN35
		8YU028													
IDSC	30	8YU033	76.39	75.02	87	67	33	38	5	6204ZZx2	20	47	14	RTWS47	RTWN47
		8YU044													
IDSH	32	8YU017	81.49	80.12	87	67	17	22	4	6204ZZx1	20	47	14	RTWS47	RTWN47
		8YU017													
IDSS	34	8YU017	86.58	85.21	95	75	17	22	4	6204ZZx1	20	47	14	RTWS47	RTWN47

▲8YU型 (兩側軸承型)

Type	Catalog No.		軸徑 d	P.D	O.D	F	E	A	W	Dh	軸承尺寸				
	齒數	齒面寬度A									No.	D	B		
IDAA	22	8YU028	12	56.02	54.65	61	45	28	33	27	6201ZZx2	32	10		
		8YU033												44	49
		8YU044													
IDAAA	24	8YU028	12	61.12	59.74	67	50	28	33	27	6201ZZx2	32	10		
		8YU033												44	49
		8YU044													
IDAH	25	8YU028	12	63.66	62.29	70	56	28	33	27	6201ZZx2	32	10		
		8YU033												44	49
		8YU044													
IDAHA	26	8YU017	12	66.21	64.84	74	58	17	22	25	6001ZZx2	28	8		
		8YU028												28	33
		8YU033													
IDAD	28	8YU044	15	71.30	69.93	80	60	44	49	27	6201ZZx2	32	10		
		8YU028												28	33
		8YU033													
IDADA	30	8YU017	15	76.39	75.02	87	67	17	22	29	6002ZZx2	32	9		
		8YU028												28	33
		8YU033													
IDSZ	30	8YU033	20	76.39	75.02	87	67	33	38	30	6202ZZx2	35	11		
		8YU044												44	49
		8YU028													
IDSC	30	8YU028	20	81.49	80.12	87	67	28	33	37	6004ZZx2	42	12		
		8YU033												33	38
		8YU044													
IDSH	32	8YU028	20	81.49	80.12	87	67	28	33	41	6204ZZx2	47	14		
		8YU033												44	49
		8YU044													
IDSS	34	8YU028	20	86.58	85.21	95	75	28	33	41	6204ZZx2	47	14		
		8YU033												33	38
		8YU044													

*例：原IDAA (中心軸承型) IDWAA (兩側軸承型)

Order	TYPE	Catalog No.	軸孔內徑
訂貨代號	IDWAA	308YU017	15

註1：如需規格表以外特殊加工，請來電告知。